



2 Bed
House - Semi-
Detached
located in Felton

£795 Per Month



HOTSPUR
RESIDENTIAL

Ground Floor

Approx. 33.9 sq. metres (364.5 sq. feet)

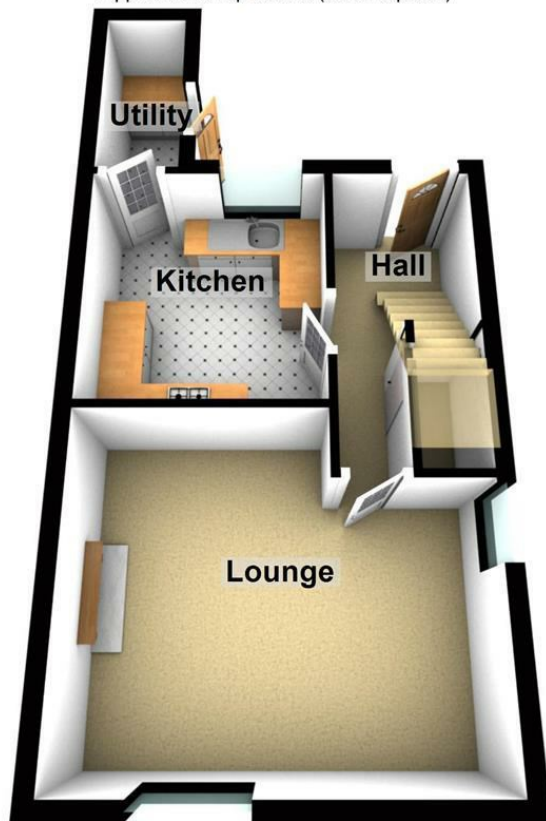

First Floor

Approx. 29.8 sq. metres (320.9 sq. feet)

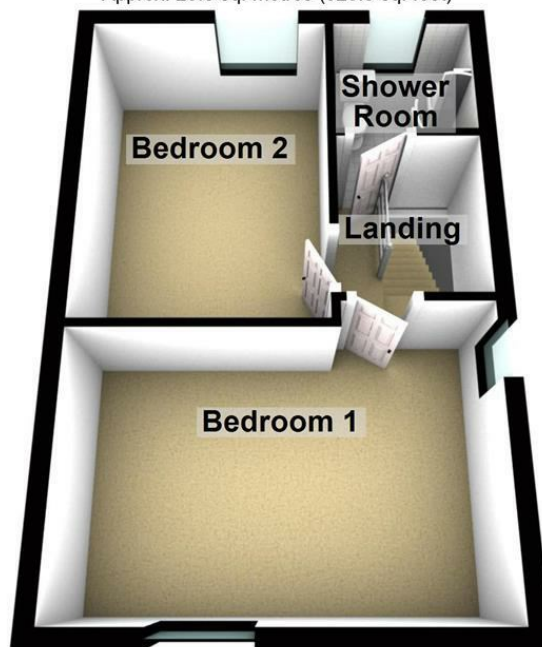

Total area: approx. 63.7 sq. metres (685.5 sq. feet)

Floor plan is approximate and is provided for visual reference only.
Plan produced using PlanUp.

Barns Road

Energy Efficiency Rating		
	Current	Potential
Very energy efficient - lower running costs		
(92 plus) A		
(81-91) B		87
(69-80) C		
(55-68) D	66	
(39-54) E		
(21-38) F		
(1-20) G		
Not energy efficient - higher running costs		
England & Wales		
EU Directive 2002/91/EC		

DIRECTIONS

CONTACT

Hotspur Residential Market Place
Alnwick
Northumberland
NE66 1HS

E: info@hotspurresidential.co.uk
T: 01665 602626
www.hotspurresidential.co.uk



HOTSPUR
RESIDENTIAL